

APPENDIX 21-6 (R)
Pass by and Diverted Linked
Trips Assignments

Revised October 2008

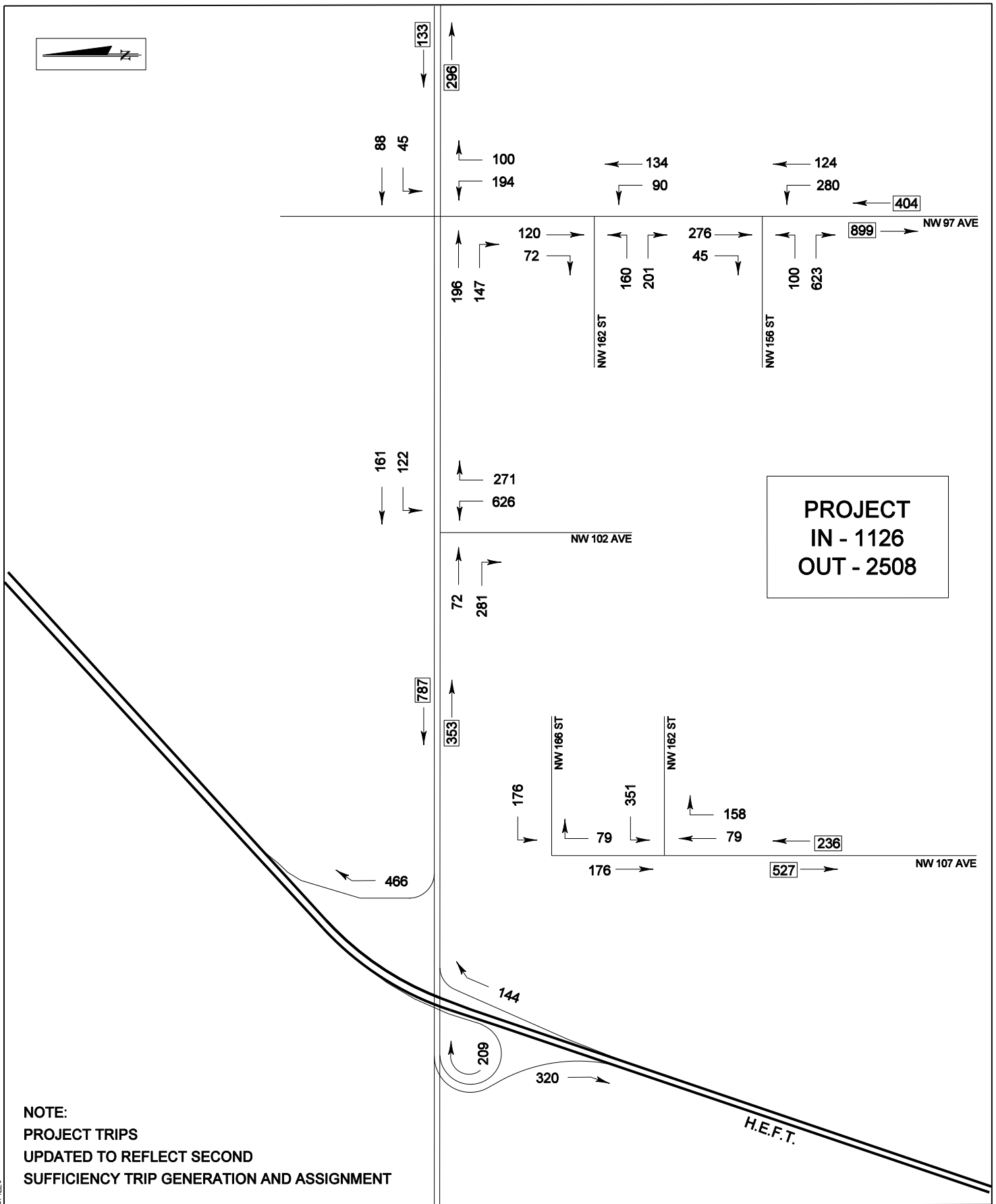

Source: David Plummer & Associates

New exhibit prepared for
October 2008 Submittal

Net New External Project Trips
Beacon County Line DRI



NW 170 ST

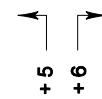
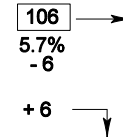
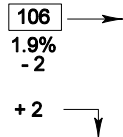
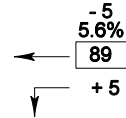
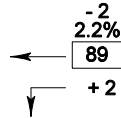

NW 97 AVE

NW 156 ST

PASS-BY	
IN	55*
OUT	55*

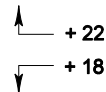
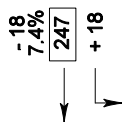

NW 102 AVE

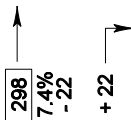

PROJECT LOCATION

LEGEND

- 00 - FUTURE W/O PROJECT
- 00 - PASS-BY
- 00% - % OF PASSING-BY VOLUME

NOTE:
PASS-BY TOTAL
REVISED OCTOBER 2008

9/FILES

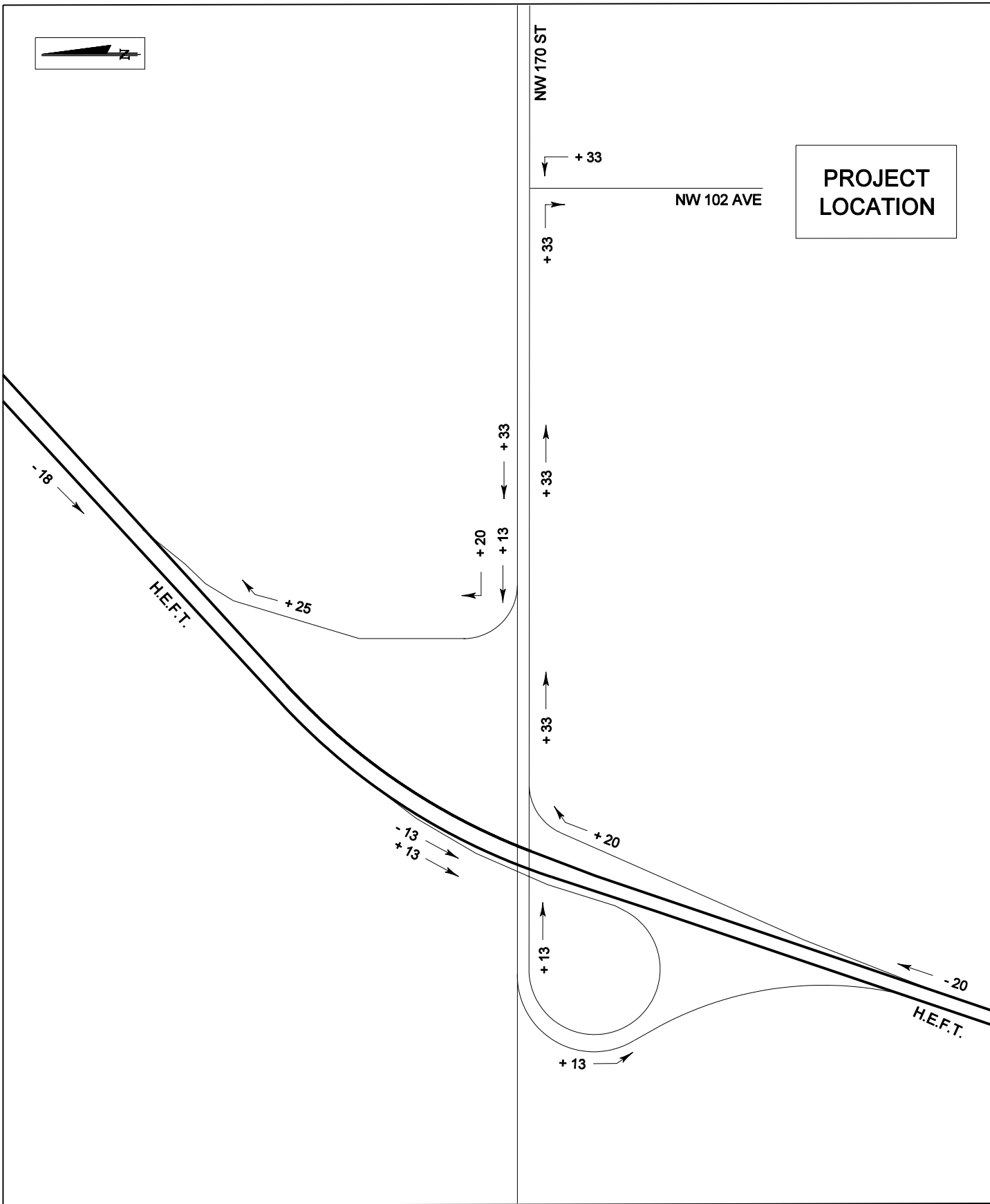

06257.dwg | Ink trips.dgn

Source: David Plummer & Associates

Diverted Linked Trips (R)

Revised April 2008

Beacon County Line DRI