



MEMORANDUM

AGENDA ITEM #7d

DATE: APRIL 7, 2008

TO: COUNCIL MEMBERS

FROM: STAFF

SUBJECT: CITY OF WEST PARK ADOPTED COMPREHENSIVE PLAN

Introduction

On March 13, 2008 Council staff received the adopted City of West Park Comprehensive Plan for review of consistency with the *Strategic Regional Policy Plan for South Florida (SRPP)*. The proposed plan was reviewed at the November 11, 2007 Council meeting and was found to be generally consistent with the *SRPP*. Staff review is undertaken pursuant to the Local Government Comprehensive Planning and Land Development Regulation Act, Chapter 163, Part II, Florida Statutes (F.S.), and Rules 9J-5 and 9J-11, Florida Administrative Code (F.A.C.).

Community Profile

The City of West Park, Broward County's newest municipality (number 31), was created March 1, 2005 and is located in southeastern Broward County. The City consists of the neighborhoods of Miami Gardens, Carver Ranches, Lake Forest and Utopia and borders Miami-Dade County on the south, Pembroke Park on the east, Hollywood on the north and Miramar on the west. The City had a population of 13,903 in 2007. The City is approaching build out. The State Road 7/U.S. 441 Corridor forms the western edge of the City. The City is a member of the State Road 7 Collaborative.

According to Chapter 163.3167(4), F.S.: "A municipality established after the effective date of this act shall...prepare and adopt a comprehensive plan of the type and in the manner set out in this act within 3 years after the date of such incorporation". The City of West Park has adopted the Broward County Comprehensive Plan until such time as the adopted City of West Park Comprehensive Plan is found in compliance with Florida Statutes.

Additional information regarding the City or the Region may be found on the Council's web site, www.sfrpc.com.

Summary of Staff Analysis

In accordance with Chapter 163, F.S., the newly incorporated City of West Park has proposed and adopted its comprehensive plan. The Broward County Land Use Plan and the Broward County Comprehensive Plan are deemed to be the controlling plans for the City until the City's adopted plan is found to be in compliance with the requirements of Chapter 163, F.S.

The City of West Park comprehensive plan includes all required elements in accordance with Chapter 163, F.S. The Plan was adopted with minor revisions to the proposed Future Land Use, Transportation, Infrastructure, Conservation, Parks, Recreation and Open Space, Intergovernmental Coordination and Capital Improvements Elements in response to the Objections, Recommendations and Comments (ORC) Report issued by the Florida Department of Community Affairs (DCA). The general location of the City is depicted in Attachment 1, and the adopted Future Land Use Map is depicted in Attachment 2. The City intends to adopt a Public School Facilities Element, complete a Capital Improvements Element Update, Water Supply Plan and related amendments later this year.

Staff analysis confirms that the Plan is generally consistent with the *Strategic Regional Policy Plan for South Florida (SRPP)*

The City voted unanimously 5-0 to approve the adopted Comprehensive Plan at its March 5, 2008 City Council meeting

Recommendation

Find the City of West Park adopted Comprehensive Plan generally consistent with the *Strategic Regional Policy Plan for South Florida*. Approve this staff report for transmittal to the Florida Department of Community Affairs.

ATTACHMENT 1

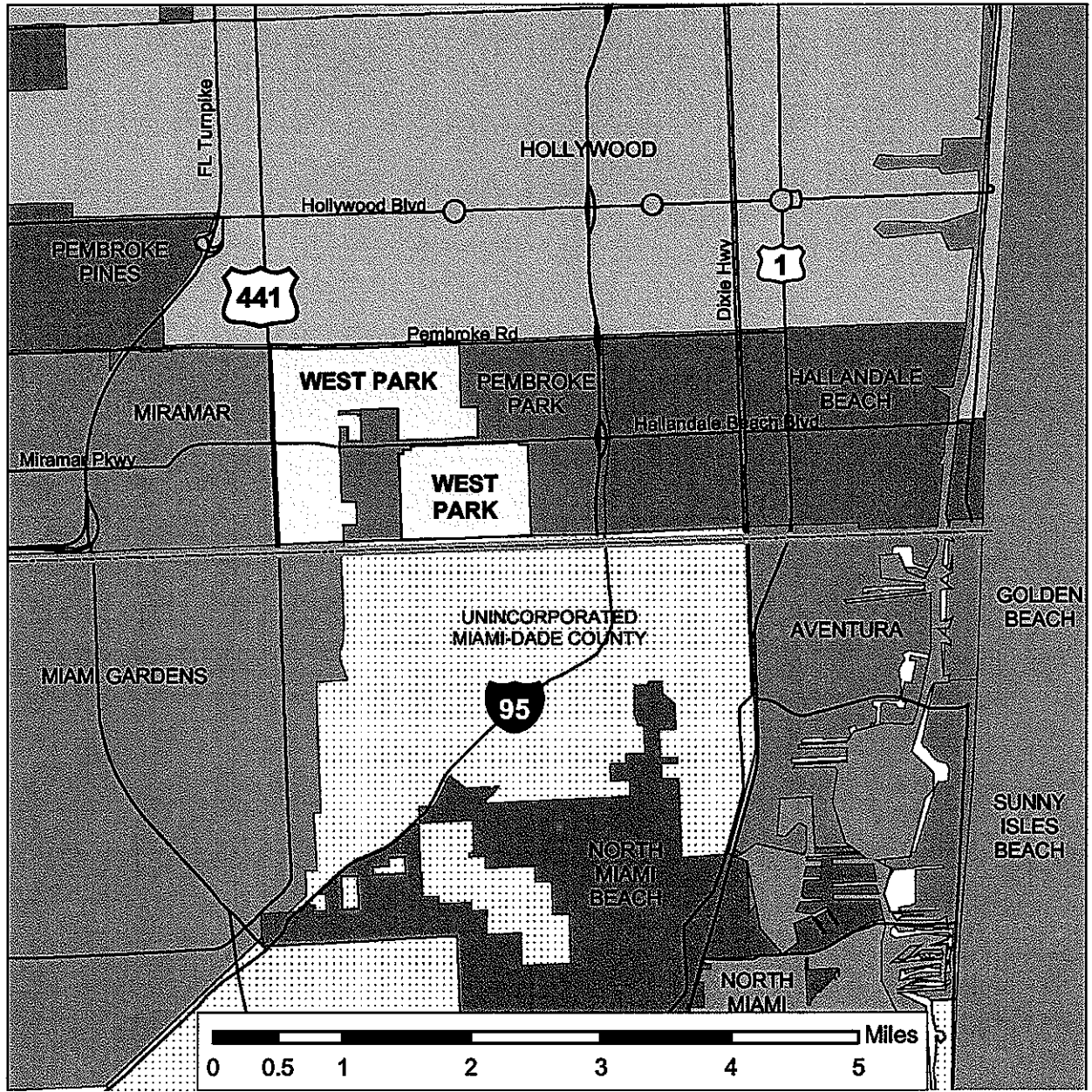

COMPREHENSIVE PLAN

Location Map

City of West Park
Adopted Comprehensive Plan

Sources: FDEP, SFWMD, Broward County, SFRPC.

Note: For planning purposes only. All distances are approximate.

ATTACHMENT 2

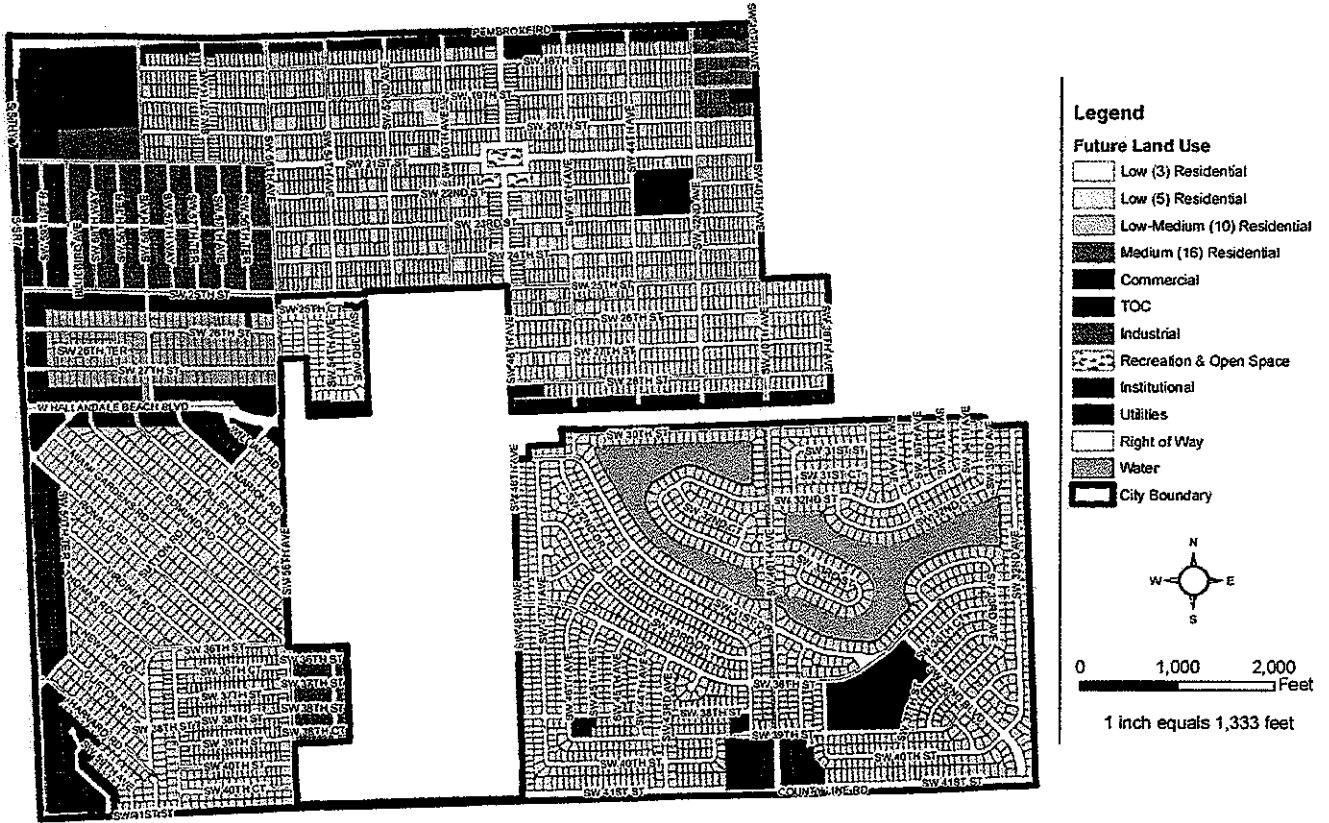

COMPREHENSIVE PLAN

Future Land Use Map

City of West Park
Adopted Comprehensive Plan

Sources: City of West Park
Note: For planning purposes only. All distances are approximate.