

**TYPICAL SECTION 2 (MIAMI DADE COUNTY)**  
**SR 7 (US 441) (S 60th AVENUE)**  
**STA. 24+80.00 TO STA. 30+00.00**

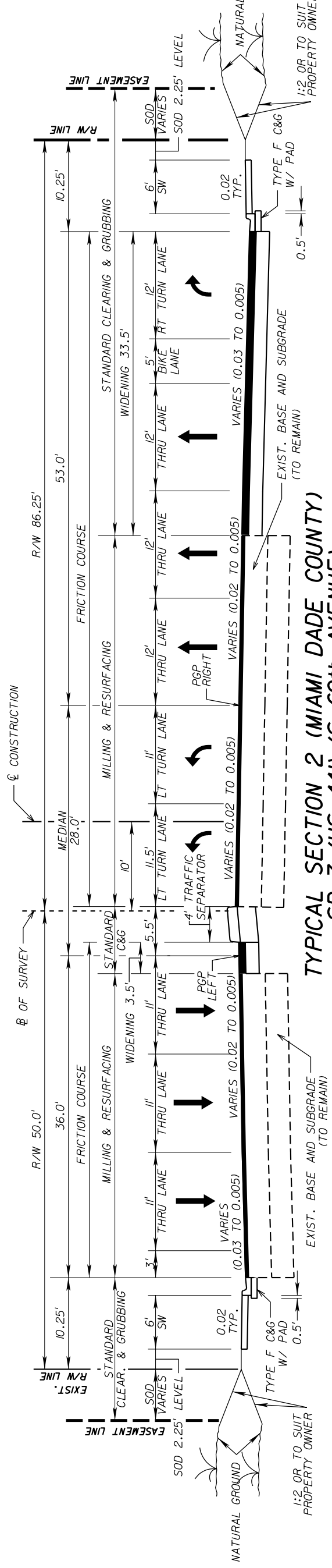

**TRAFFIC DATA**

CURRENT YEAR ESTIMATE = 2002 AADT = 48,300  
 OPENING YEAR ESTIMATE = 2009 AADT = 53,400  
 DESIGN YEAR ESTIMATE = 2029 AADT = 68,200  
 K = 9 % D = 56% T = 3 % (24 HOUR)  
 DESIGN HOUR T = 2 %  
 DESIGN SPEED = 45 MPH

**TYPICAL SECTION NOTES**

1. CURB PADS SHALL BE CONSTRUCTED OF 4" MIN. TYPE B-12.5 UNLESS OTHERWISE NOTED AND ARE INCLUDED IN THE UNIT PRICE FOR THE APPROPRIATE CURB OR CURB AND GUTTER.

MILL EXISTING ASPHALT PAVEMENT (2.5" AVG. DEPTH) RESURFACING

TYPE SP OVERBUILD COURSE (AVG. 750 LBS/SY)  
 TYPE SP STRUCTURAL COURSE (TRAFFIC C) (100 LBS/SY)  
 AND FRICTION COURSE FC-12.5 (FC-6) (160 LBS/SY) (RUBBER)  
 WIDENING

OPTIONAL BASE GROUP 14, TYPE B-12.5 ONLY, WITH  
 TYPE SP STRUCTURAL COURSE (TRAFFIC C) (150 LBS/SY)  
 AND FRICTION COURSE FC-12.5 (160 LBS/SY) (RUBBER)

REVISIONS	
DATE	DESCRIPTION

ENGINEER OF RECORD:  
 JAMES EUGENE FORD, P.E. # 47526  
 3400 W. COMMERCIAL BLVD.  
 FORT LAUDERDALE, FL 33309

STATE OF FLORIDA	
DEPARTMENT OF TRANSPORTATION	
ROAD NO.	COUNTY
7	BROWARD
FINANCIAL PROJECT ID	
22773-1-52-01	